

30 min

① 3.5x18  
DIN7505B  
**x 4**

② M5x16  
DIN7985  
**x 3**

③ M5x30  
DIN7985  
**x 3**

④ M5  
DIN4032  
**x 1**

⑤ M4x12  
DIN7046  
**x 4**

⑥ M5x5  
DIN7985  
**x 4**

⑦ 3.5x16  
DIN7505A  
**x 6**

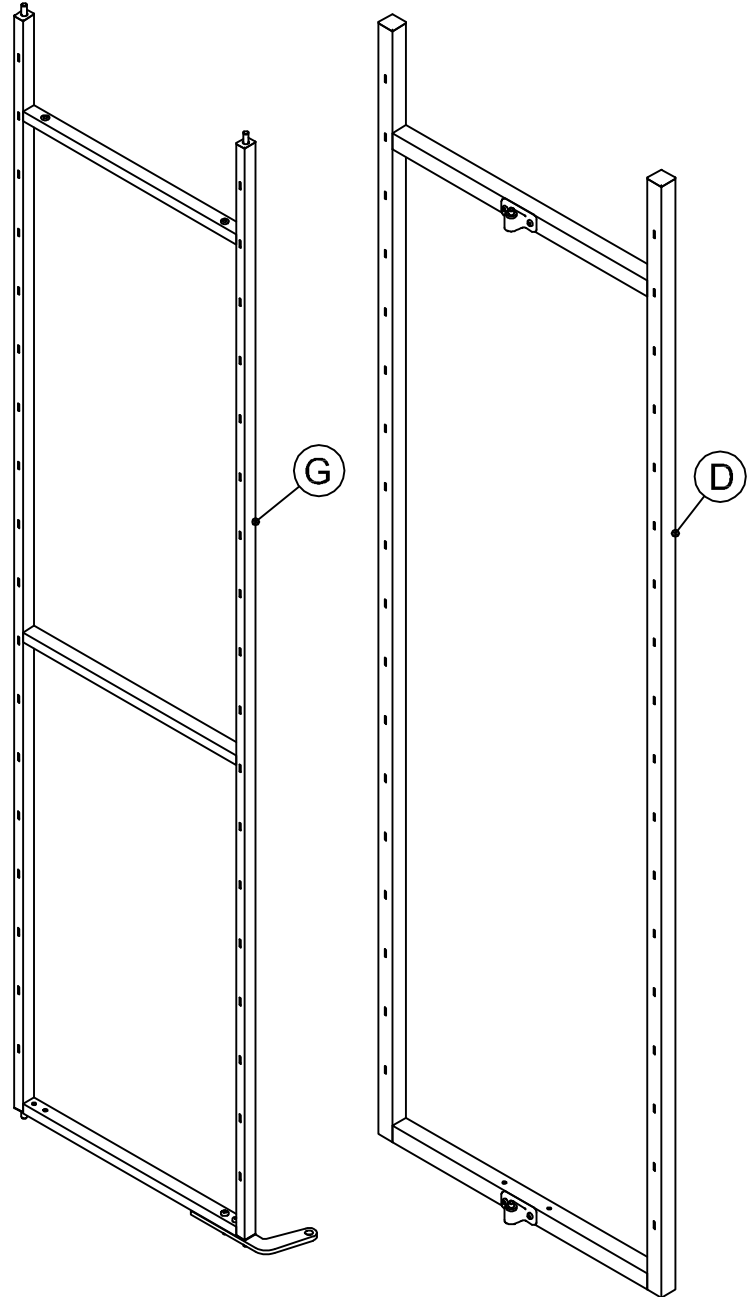
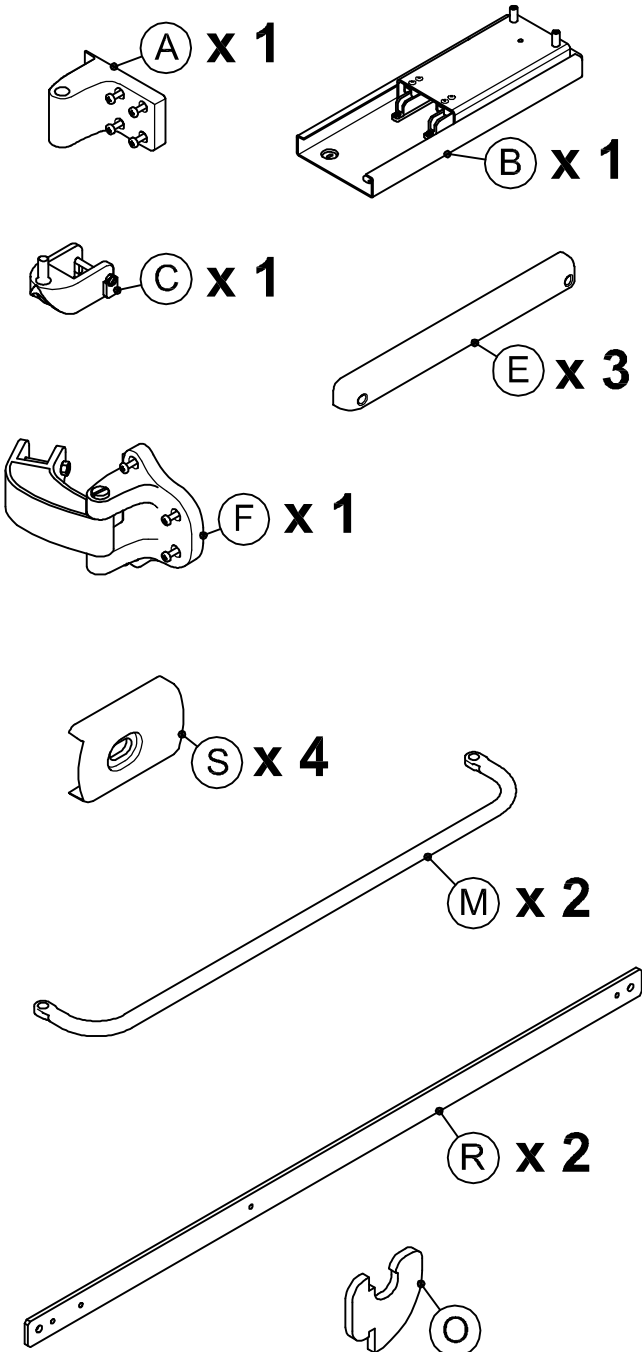

⑧ N x 2

⑨ H x 1

⑩ I x 1

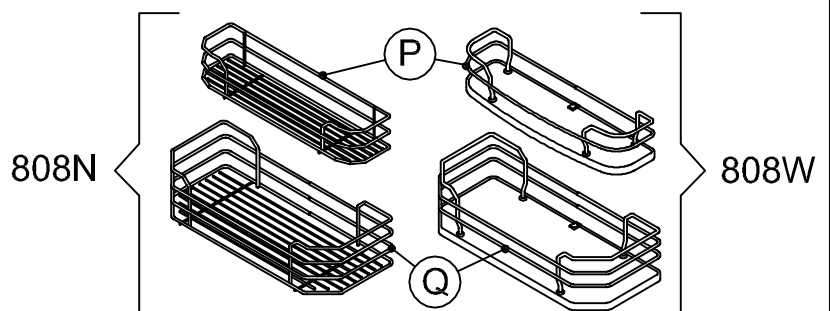

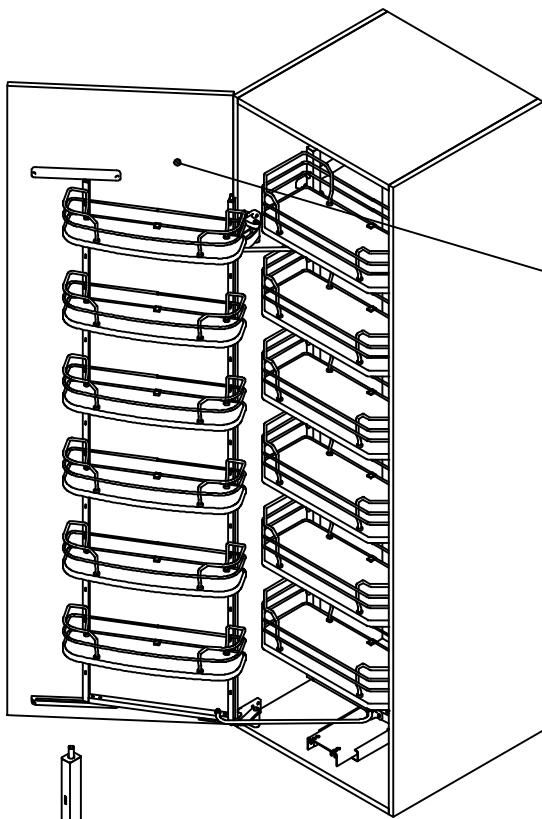

Il meccanismo viene fornito per il montaggio con anta a sinistra. Per il montaggio con anta a destra occorre modificare il telaio G come segue.

*Mechanism is supplied for left door mounting. For right door mounting it is necessary to change frame "G" configuration as follows.*

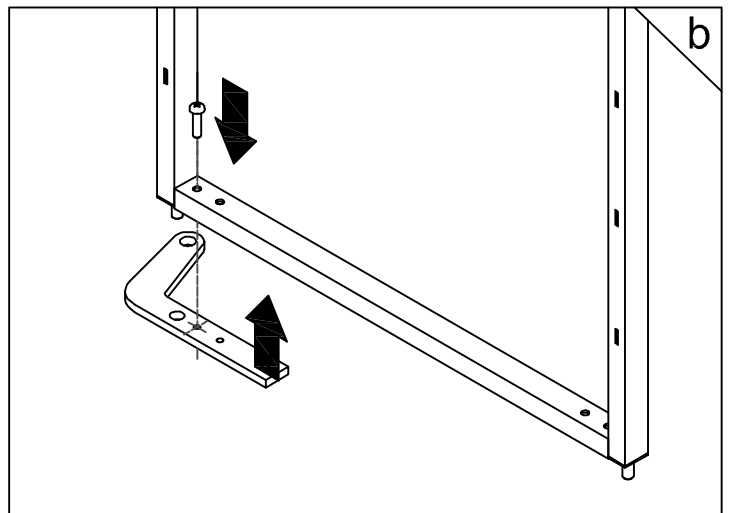
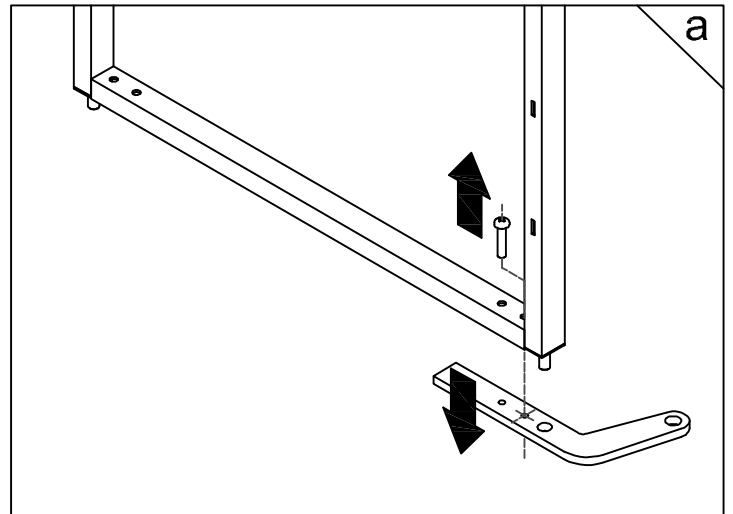
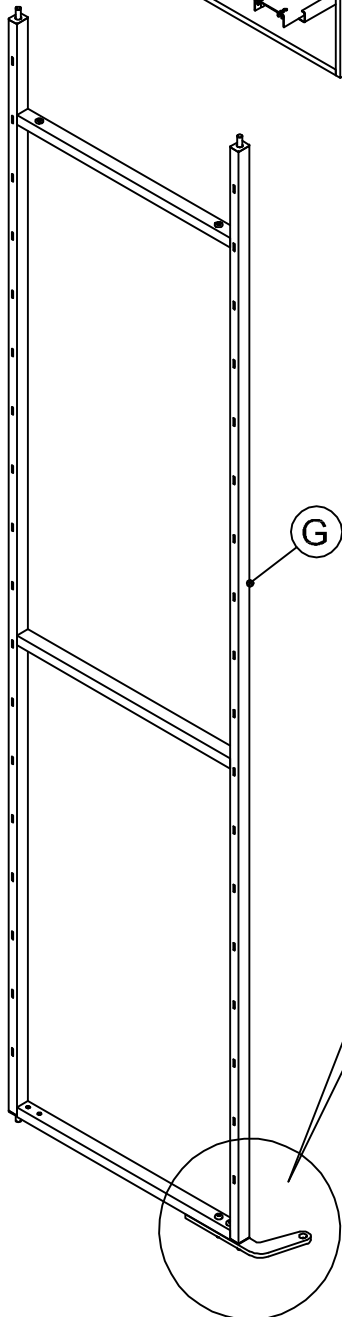

Le seguenti istruzioni si riferiscono al montaggio con anta sinistra. Per il montaggio con anta destra occorre posizionare i componenti contrassegnati con ☒ sul lato opposto.

*Following instructions refer to left door mounting. For right door mounting place the ☒ signed components on the opposite side.*

1

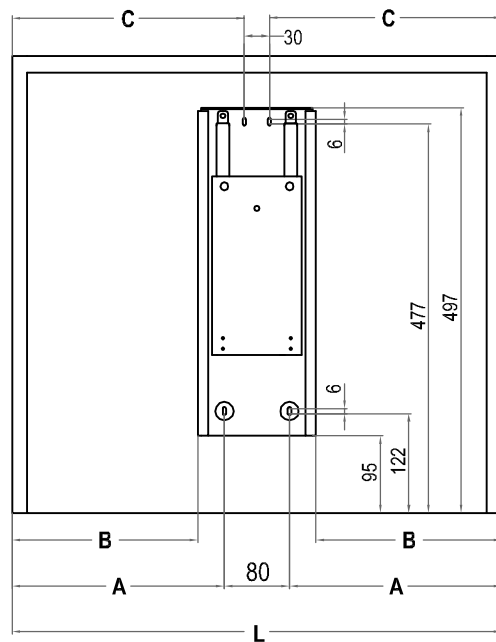
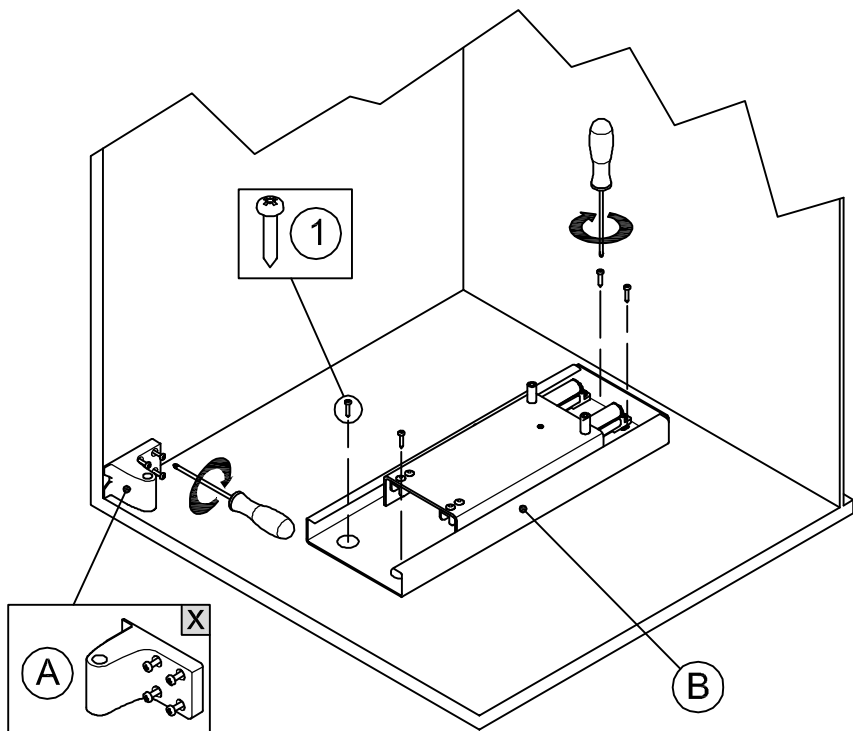

L [mm]	A [mm]	B [mm]	C [mm]
600	260	227.5	280
450	185	152.5	205

2

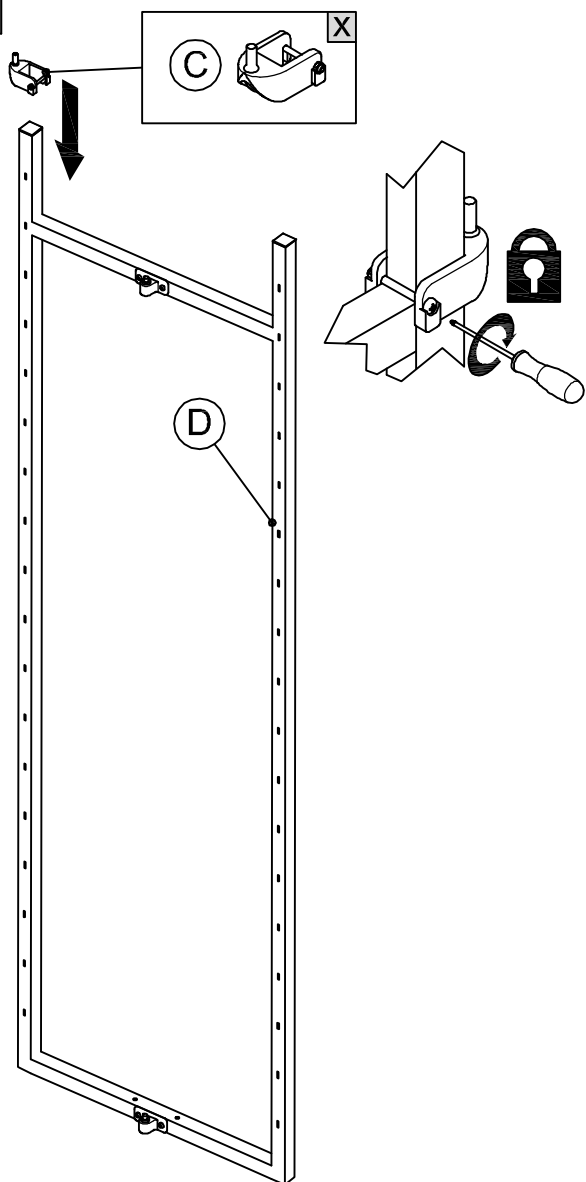

3

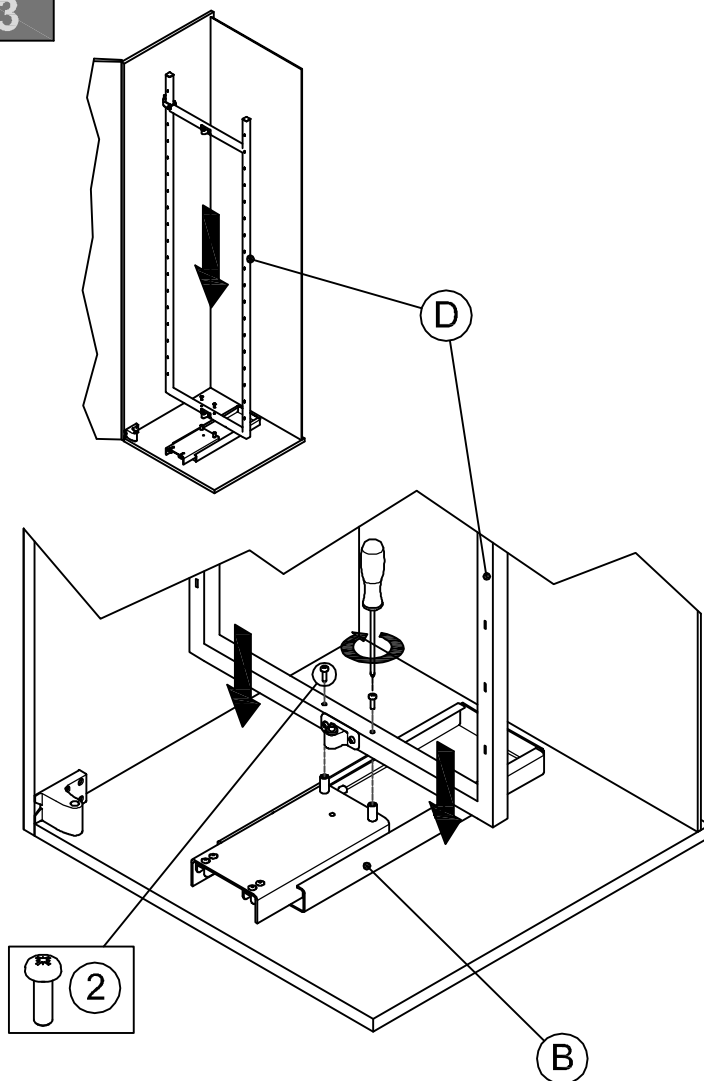

4

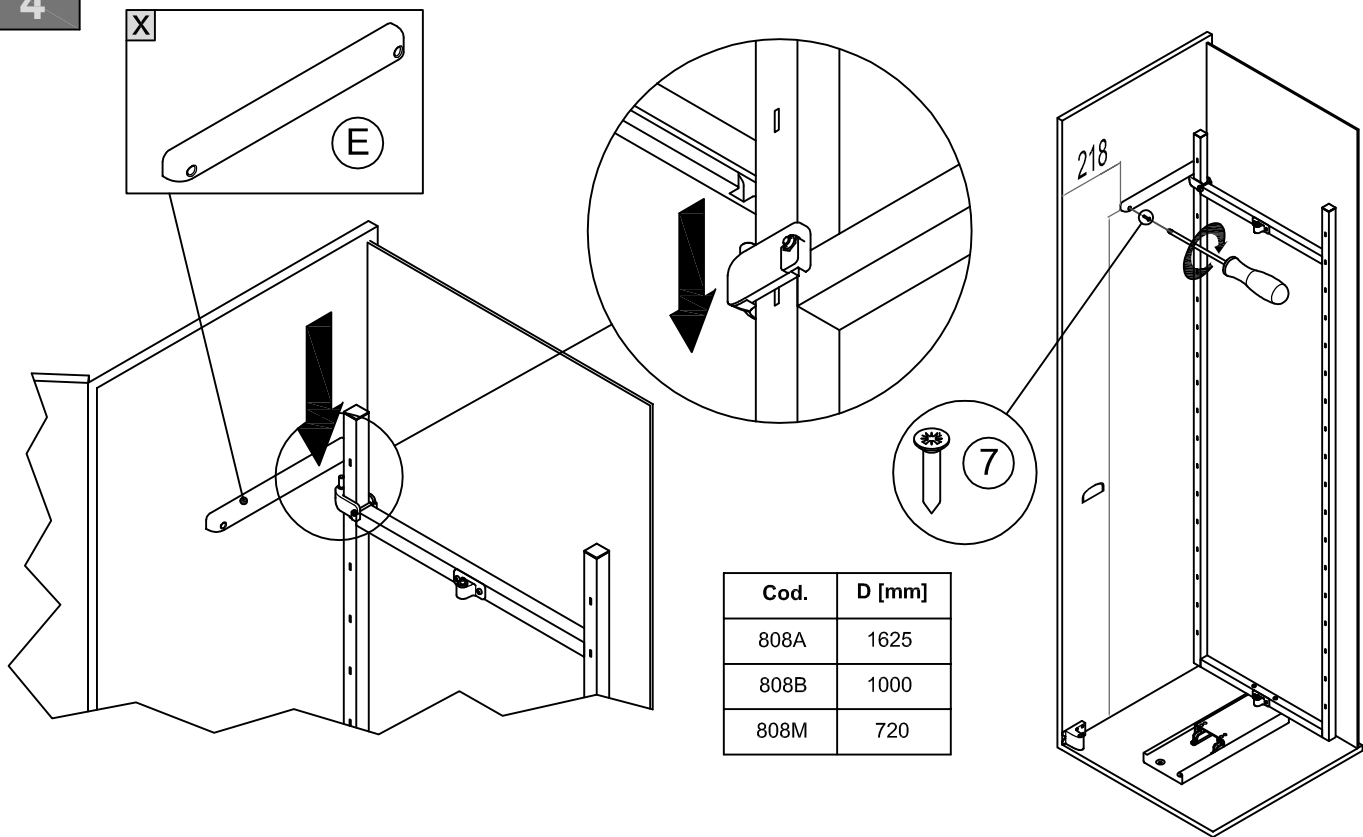

5

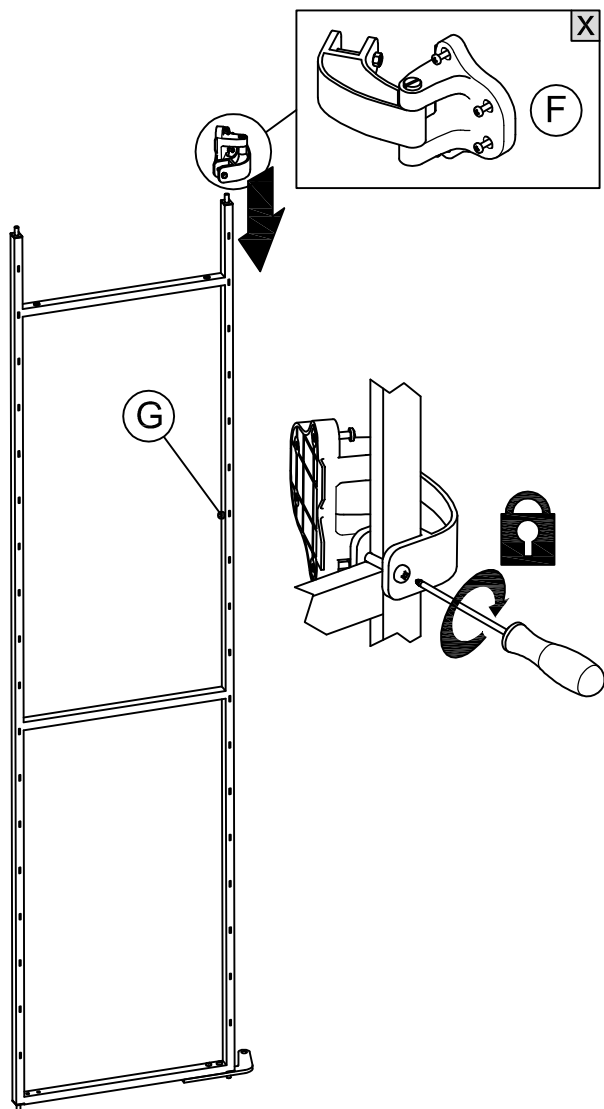

6

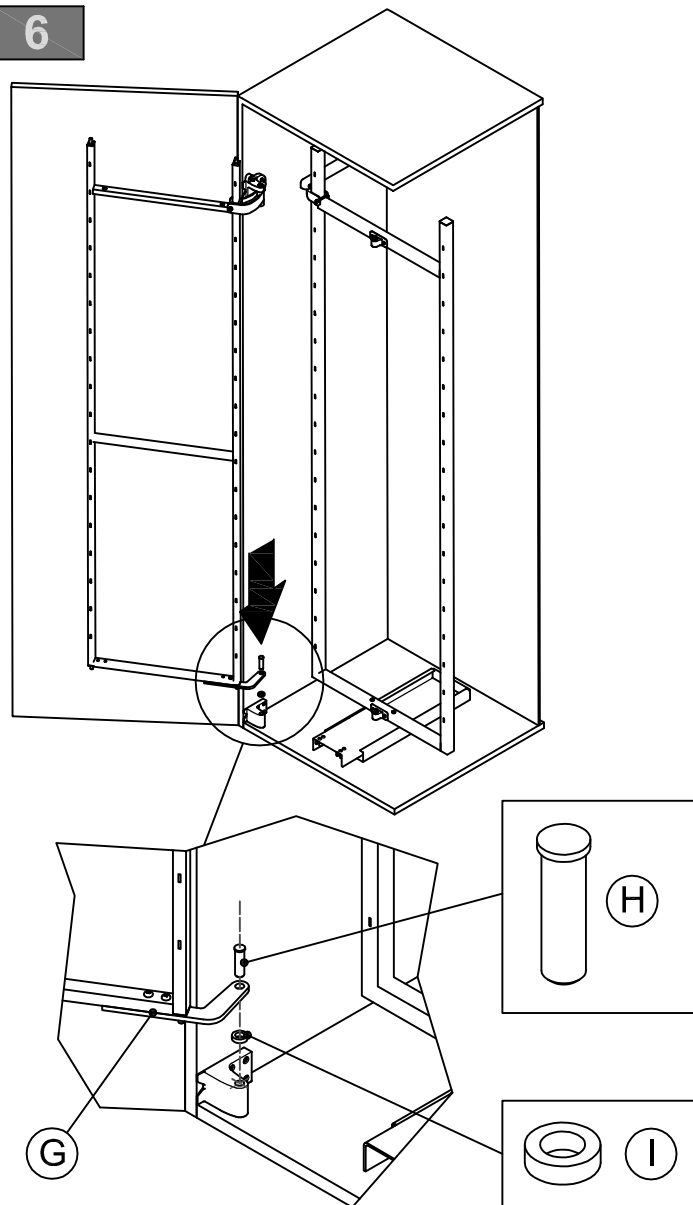

7

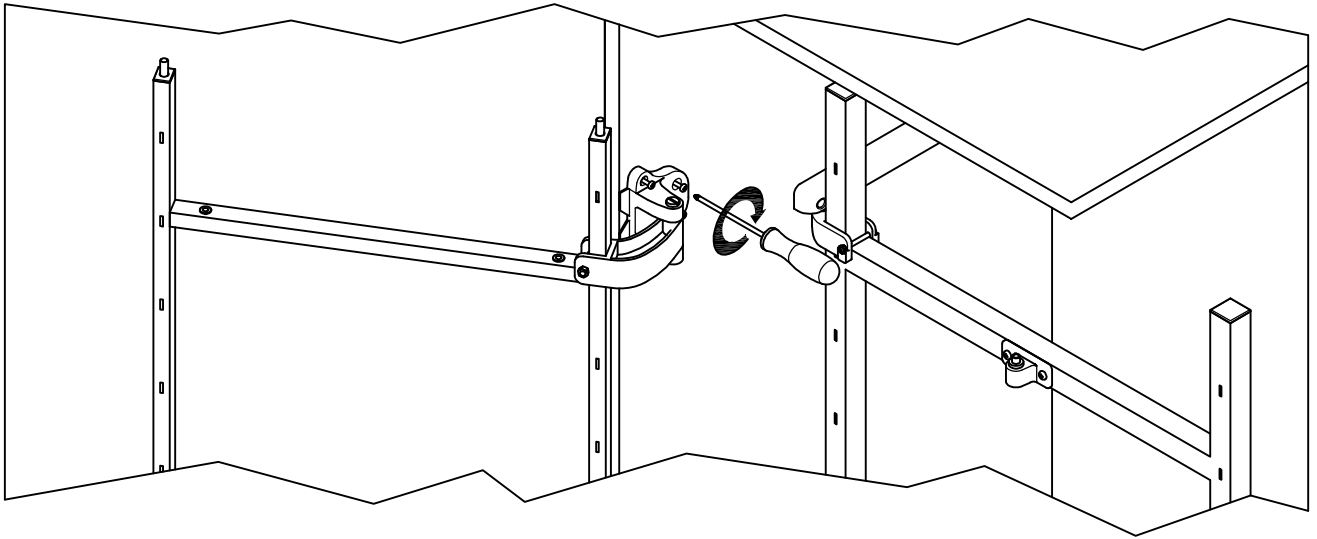

8a

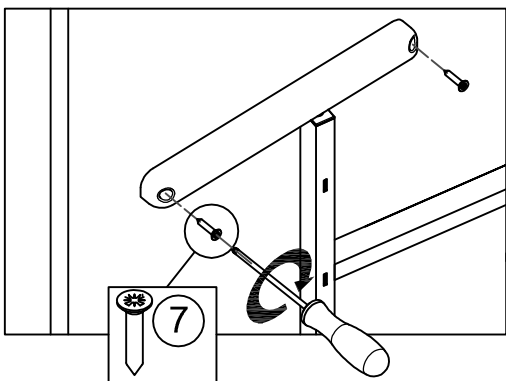
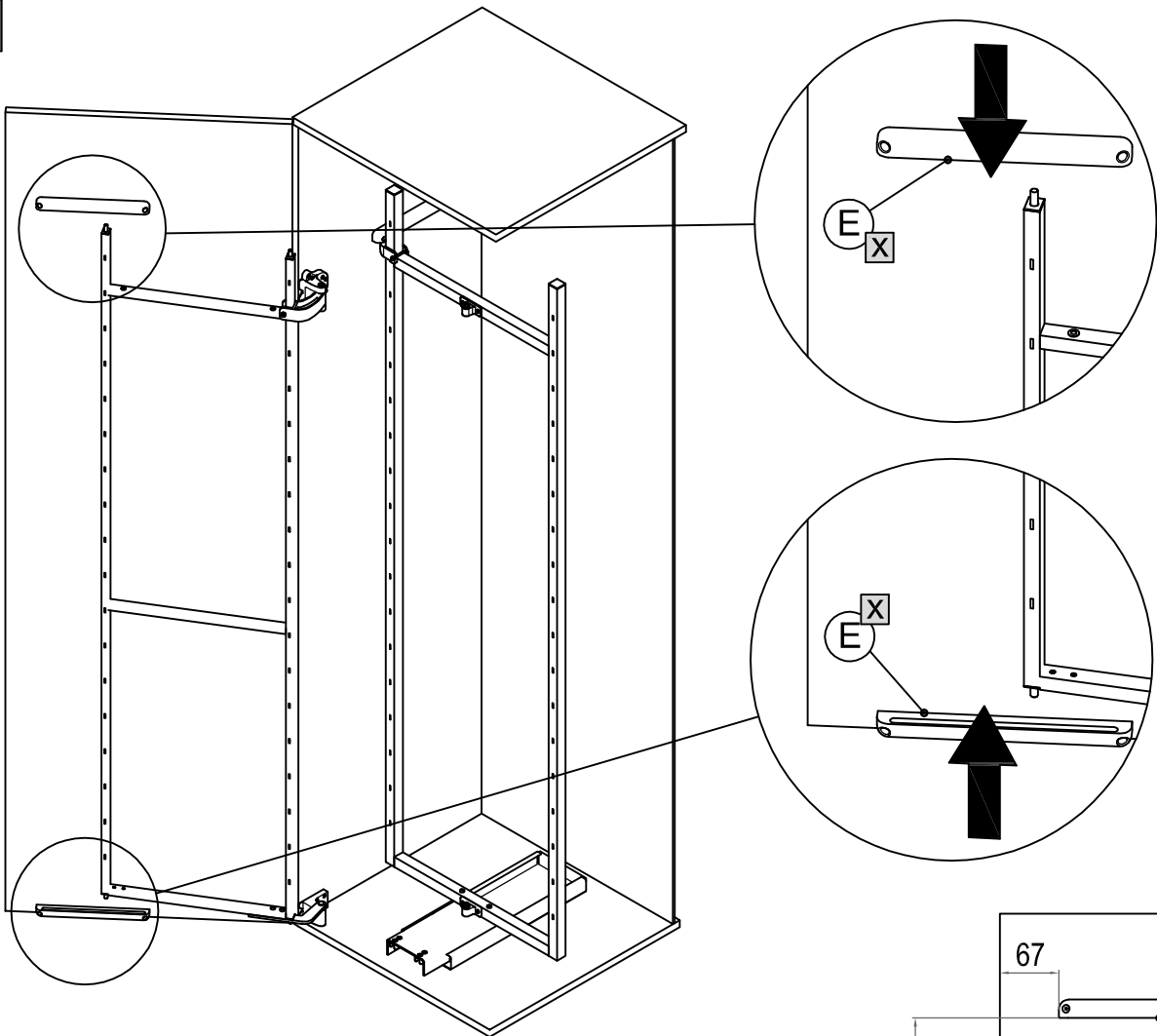

Cod.	E [mm]
808A	1762
808B	1137
808M	857

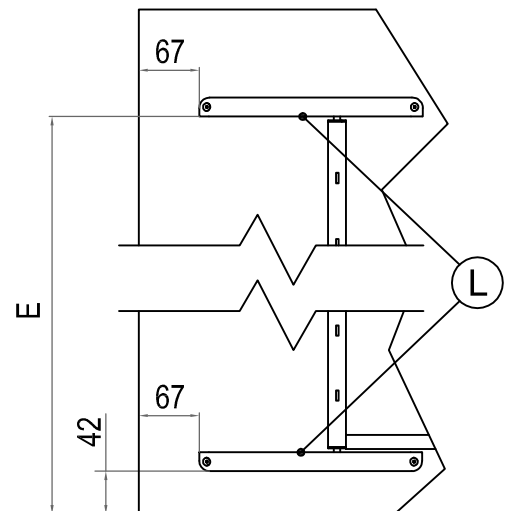

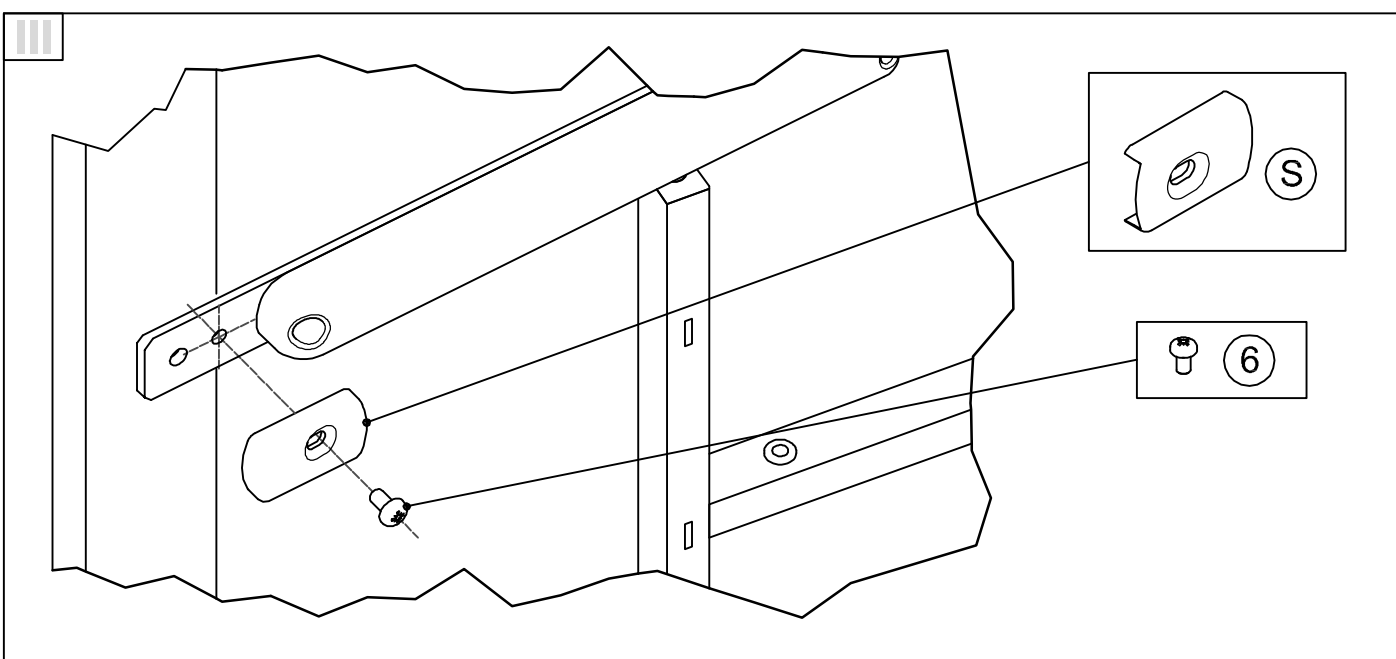
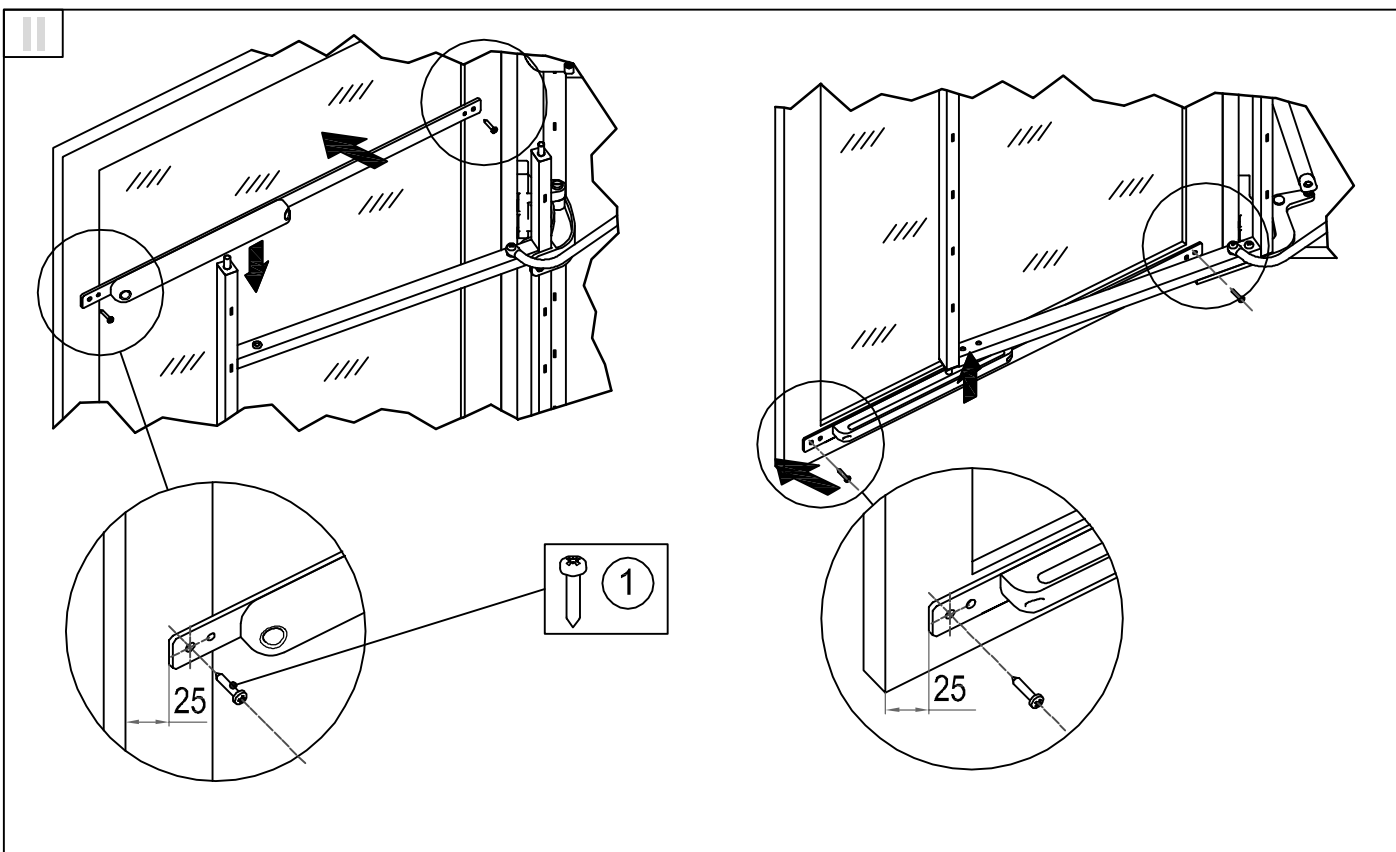
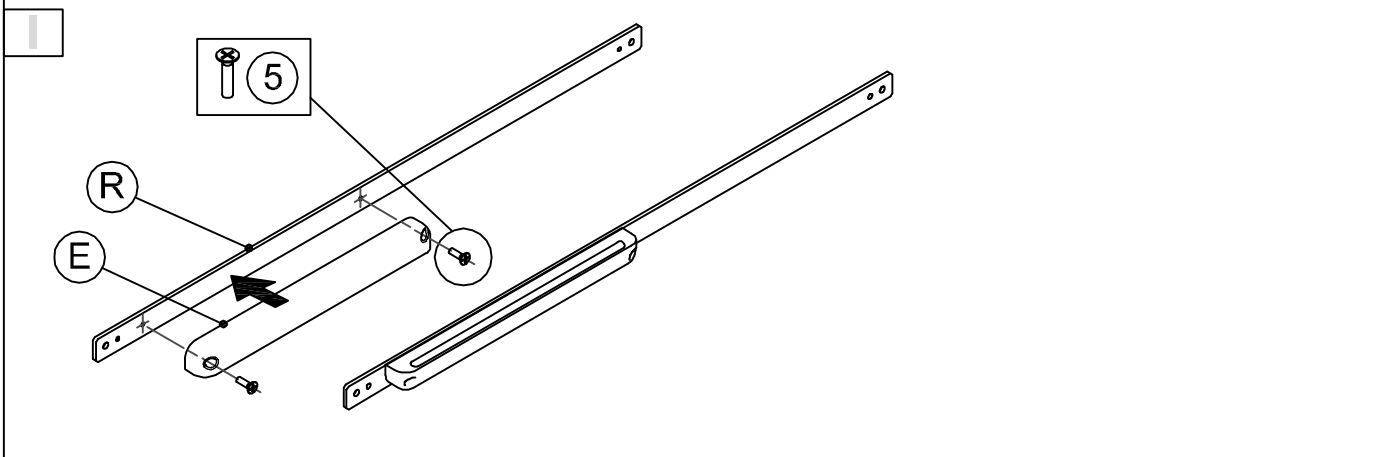

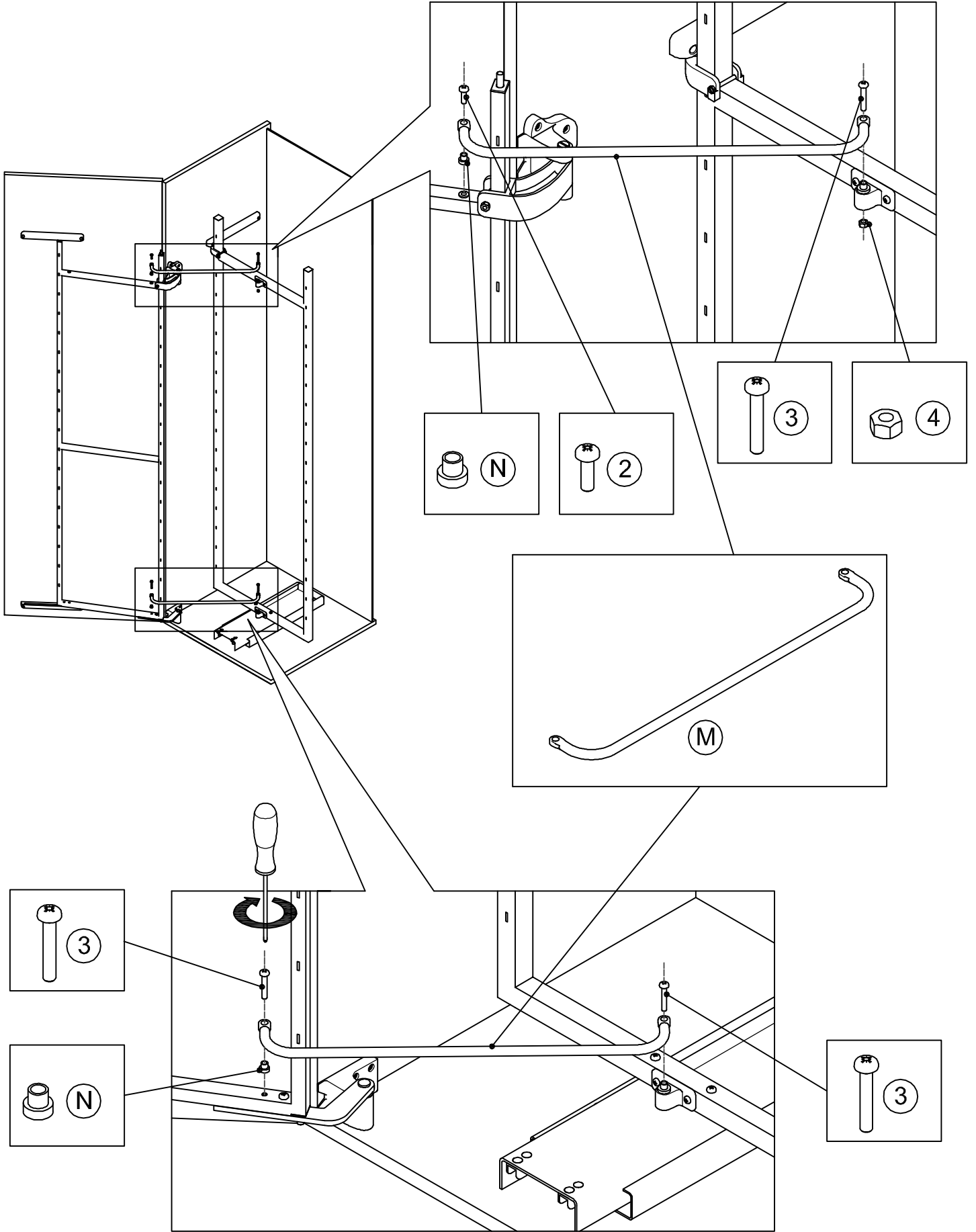

10

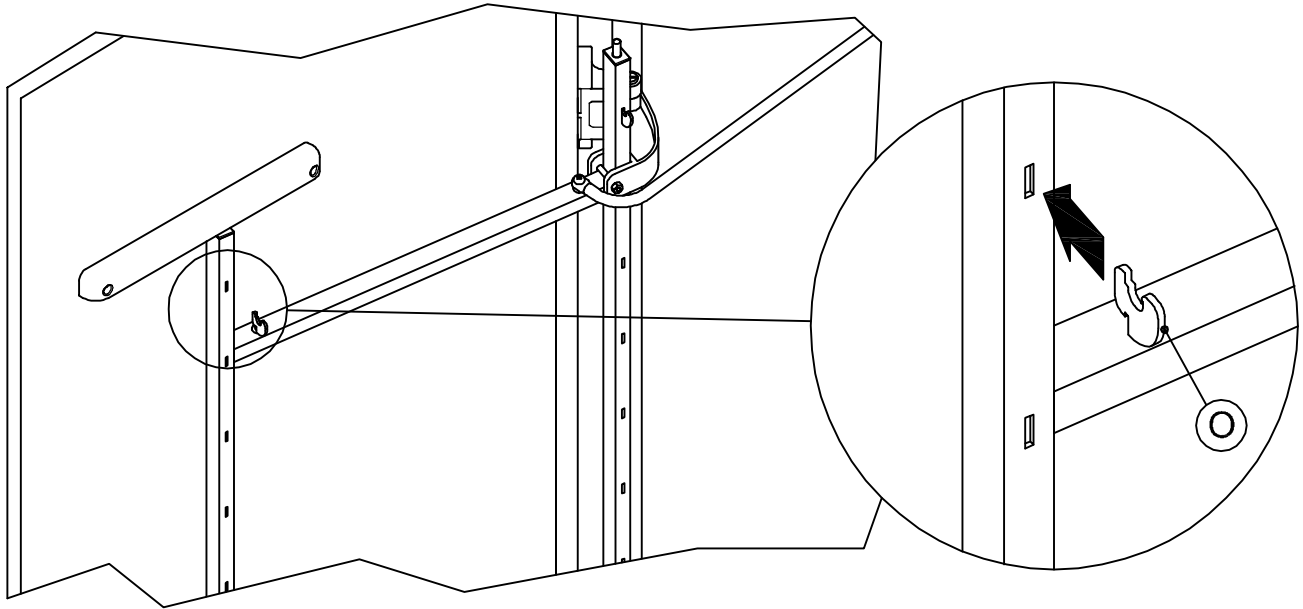

11

